

A photograph of a modern building's exterior. The building features a curved glass facade that reflects the surrounding environment. Above the glass, there is a curved ceiling made of horizontal wooden slats. Several vertical metal poles support the ceiling. The ground in front of the building is paved with concrete and has some large rocks. The overall scene is brightly lit, suggesting daytime.

EXTERIOR FINISHES

LINEA

CEILING & WALL SYSTEMS

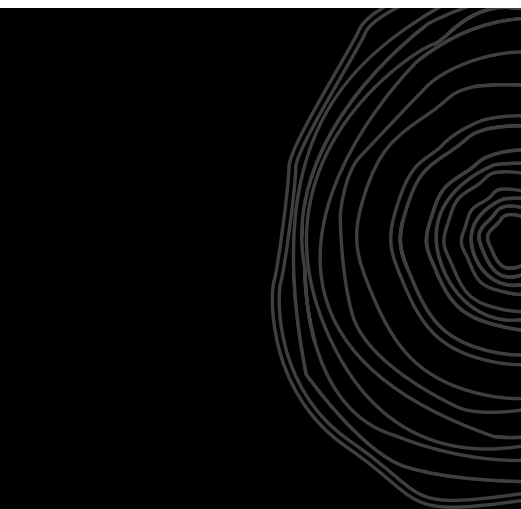
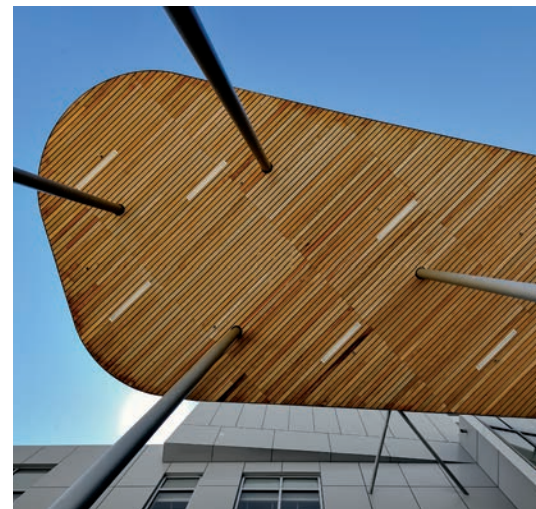

LINEA FOR EXTERIORS

A selection of LINEA solid wood products can be installed in covered exterior environments such as soffits, overhangs or vertical siding no matter the climate. To ensure LINEA products hold up to the various rigors of these environments, a specially formulated, high-quality, highly-durable exterior finish must be applied to all faces and edges of each wood member.

To help extend the life of the exterior finish, LINEA products should be installed away from direct or prolonged contact with rain, snow, standing water or the harmful rays from direct sunlight.

Please note that some wood species are naturally better performers in outdoor environments than others such as Western Red Cedar, Alaskan Yellow Cedar, Douglas Fir and Western Hemlock. Wood veneers adhered to MDF or Particleboard should not be used in an exterior environment due to likelihood of cracking and delamination caused by expansion and contraction from changes in temperature and relative humidity.

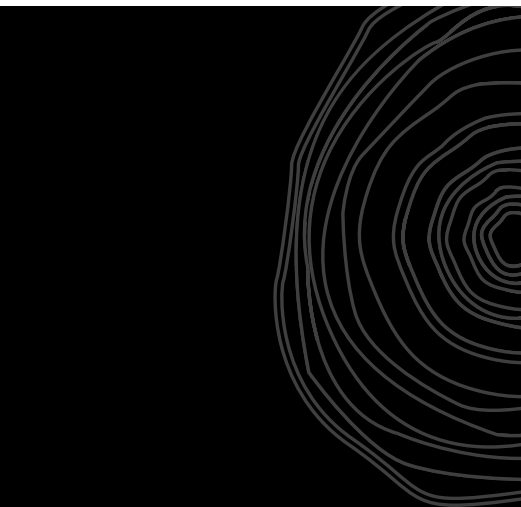
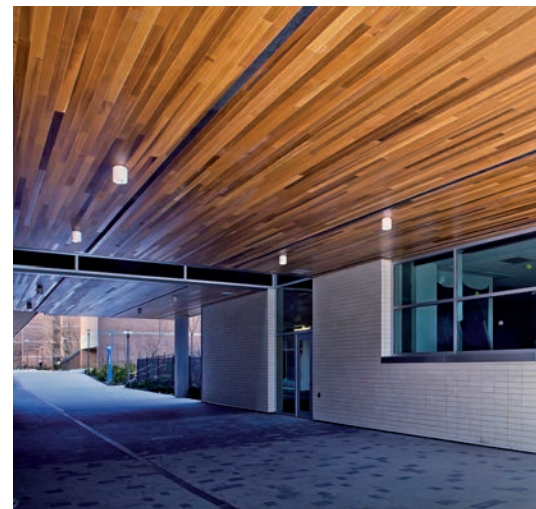

EXTERIOR FINISH PROPERTIES

- Environmentally friendly
- Easily re-applied in field
- High solids
- Moisture resistant
- Tough, durable finish
- Non flammable liquid
- Excellent adhesion to wood
- Excellent gloss retention
- Exceptionally UV resistant
- Chemical resistant
- Water Repellent
- Bonds with Fire Retardant Treatment

MAINTENANCE FOR EXTERIOR FINISHES

Surfaces may require maintenance every 5-15 years and is only necessary when the surface shows signs of wear such as, clouding, fading or erosion. Maintaining your surface on a regular basis will ensure long-lasting color retention, dimensional stabilization and effective water repellency. Maintenance coat frequency will depend on the quality of prior preparation, substrate quality, construction quality, quality of application and degree of exposure. Prior to re-finishing, surfaces must be inspected for defects and repaired as necessary. Lightly sand, clean and dry prior to re-application in the field by brush or spray.

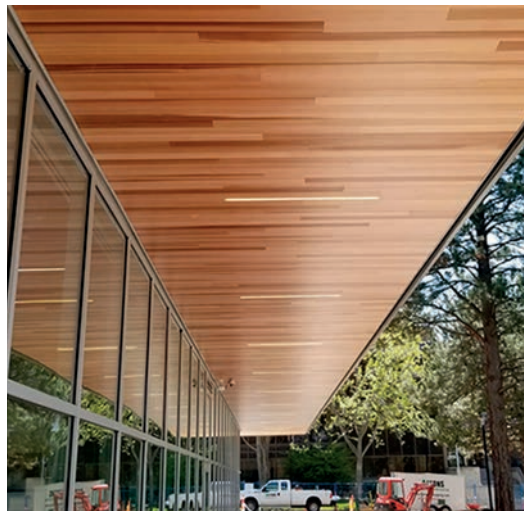

SUITABLE WOOD SPECIES FOR EXTERIORS

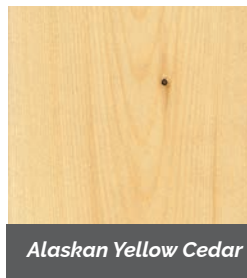

Please contact a **LINEA** representative for more info about which wood products should be used outdoors.