

LINEA **PET BACKER** *(Polyethylene Terephthalate)*

LINEA PET Backer is a fantastic, eco-friendly, all-in-one substitute for traditional wood backers and fabric scrims for many of our wall and ceiling products. LINEA PET Backer is a decorative panel substrate offering exceptional acoustic performance with a smooth, fabric-like finish. PET material is semi-rigid, light weight and with its sound absorbing properties, LINEA PET Backer can replace the need and expense for separate acoustical insulation and framing behind the panels.

PET material is made of 100% non-woven polyester fiber; at least 60% of which is generated from post-consumer content such as recycled plastic beverage containers which makes LINEA PET Panel 100% recyclable! PET material is non-hygroscopic, anti-microbial, anti-fungal and free of volatile organic compounds (VOC's) like formaldehyde.

LINEA PET Backer offers these benefits in a range of colors and thicknesses sure to enhance any interior building space.

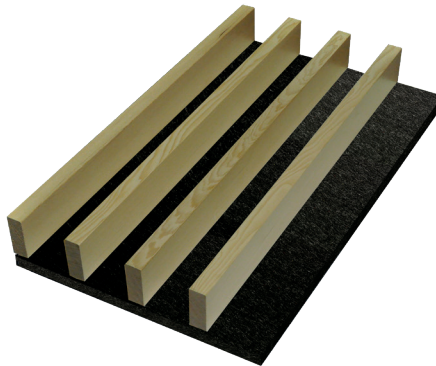

LINEA PET Backers

Can be integrated with the following products

- LINEA Grille • LINEA Plank • LINEA Mixed Grille • LINEA Tegular Grille • LINEA Tegular Plank

Section Detail

Ceiling Install

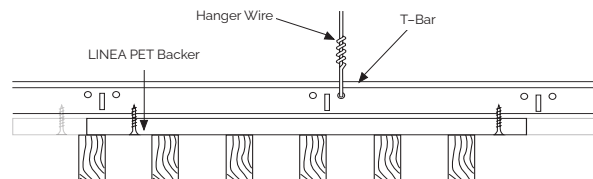

Wall Install

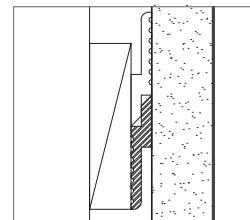

TECHNICAL INFORMATION

PET Types:	Class A Fire Rated and *Non-Fire Rated
Fire Rating:	Class A (ASTM E84)
Core Material:	100% Polyester Fiber (60% PET-Recycled Fiber, 40% PET Virgin Fiber)
Edge:	Square
Size:	1225mm x 2800mm (4' x 9' Nom)-Class A 1220mm x 2440mm (4' x 8' Nom)-Class C
Thickness:	12mm (1/2") or 24mm (1")
Finish:	Mixture of Rough & Smooth
Colors:	15+ (Class A Fire Rated) and *30+ (Non-Fire Rated)
NRC Rating:	0.40-1.00 (depending panel thickness and mounting options)
Weight:	12mm (1/2")-2300 g/m ² (0.47 lb/ft ²) 24mm (1")-3500 g/m ² (0.72 lb/ft ²)
Density:	12mm (1/2")-190kg/m ³ (11.7 lb/ft ³) 24mm(1")-160kg/m ³ (10lb/ft ³)
Installation:	Adhesive or Mechanical Fasteners as required
Use:	Interior use only



ACOUSTICS

LINEA PET PANELS		
Thickness	NRC-Direct Mount	NRC-With Air Gap**
1" (24mm)	0.60	1.00
1/2" (12mm)	0.40	0.90

Acoustical performance improves as air gap behind the panel increases. Performance will vary by product type and is dependent on open area percentage between wood slats.

****Based on 200mm air gap.**

COLORS (CLASS A)

Additional colors available for non-fire rated panels (Class C)

BLACK	WHITE	CHARCOAL	DARK GRAY	LIGHT GRAY	MARBLE	ICY	SNOW
RED	ORANGE	YELLOW	GREEN	NAVY	BLUE	BEIGE	SAND

Disclaimer

Maximum Panel lengths for Class A Fire Rated PET Backers (108" / 2800mm) and Non-Fire Rated (96" / 1220mm). Variation in thickness, fiber mix and color as well as flecks and other slight surface blemishes are an inherent feature of this product and are unavoidable. Variation from batch to batch may occur. Custom Thicknesses and Colors are available and are subject to minimum order quantities.

Contact LINEA for details